

Woodward II

6691 Single Cylinder

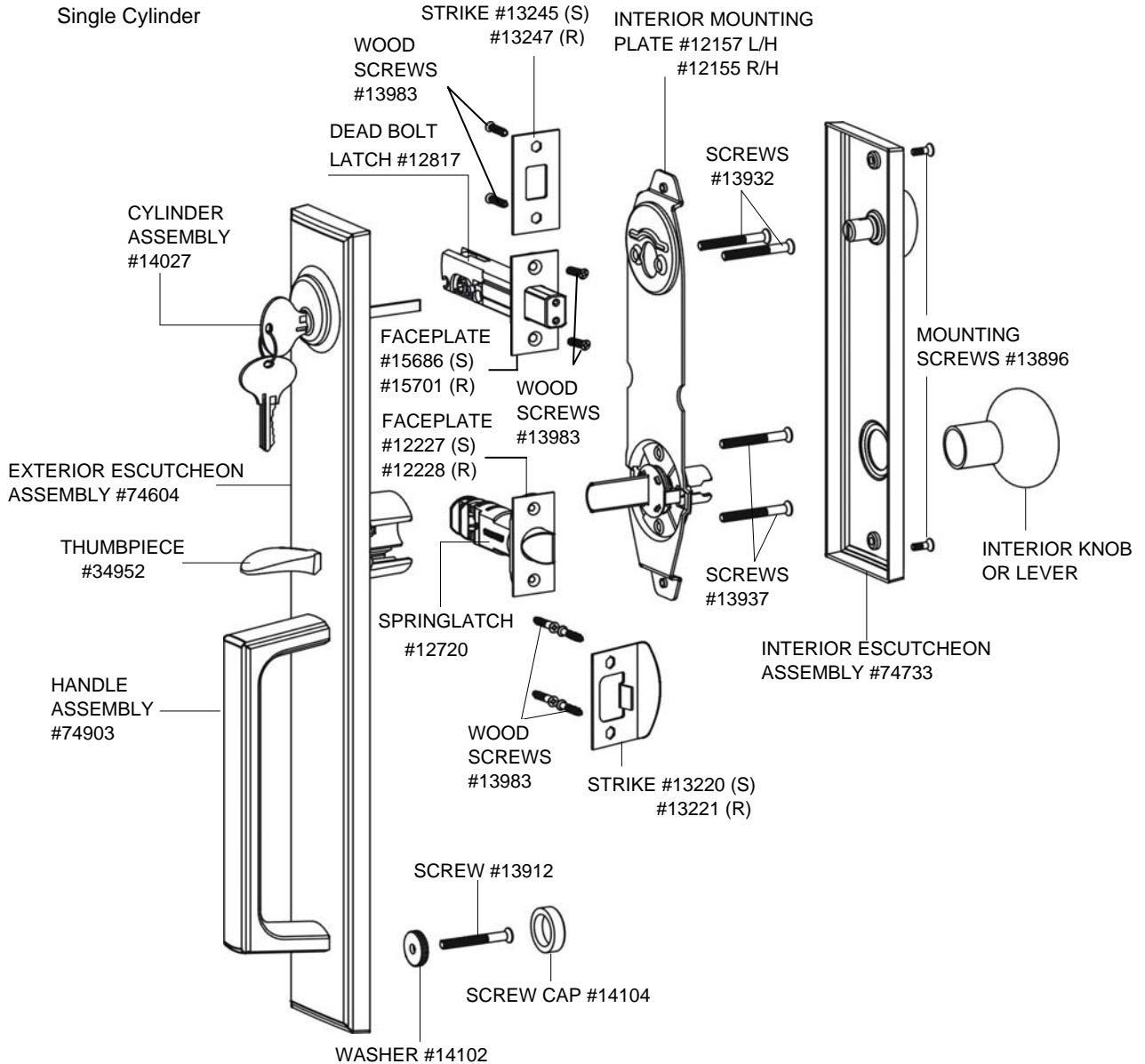

Note: Exterior Handle Assembly and Interior Assembly accommodates standard door thickness 1 3/4" to 2" (44-51 mm)

* Finishes available: (N, 1)

Cylinder Assembly			
	Single	Double	Dummy
Cylinder Assembly	14027	14746	N/A
Cylinder Tailpiece	14568	14745	N/A
Cylinder Retaining Screw	13910	13910	13910
Cylinder Cap	14247	14247	14247
Cylinder Pin Drive	14041	14041	14041

Latch & Strike Screws	
Wood Door & Jamb (8 Each)	13983
Metal Door & Jamb (8 Each)	13903
3" Wood Screw (2 Each)	13969
Knob & Lever Styles	
Interior Knob/Lever	Style
12013	Impresa Knob
12912	Non-Handed Utica Lever